



Hose Reels

Hose Diameters: 100, 125, 150mm

Hose Lengths: up to 10m

Wall or Ceiling mounting

Motorised or Spring Controlled

Optional Remote Control

Exhaust gases up to 150°C



Perfect exhaust solution for:

- **CAR FUMES**
- **GASES**

and many more...

Hose Reels

Oskar Exhaust Hose Reels are designed to facilitate the extraction of fumes and gases produced by automobiles in locations such as repair and maintenance facilities. Reels can also be used in other very remote areas to provide extraction of fumes in areas such as hulls of ships or tanks. Hoses are available at temperature ratings up to 150°C. The reel is fabricated from steel components which are either galvanised or painted. The hose of the reel is stored on a drum. The spring mechanism (in spring driven series) allows for easy unrolling and automatic retraction of the flexible hose. The hose may be locked in place by means of the ratchet locking system. Electric motor driven versions of Oskar Exhaust Hose Reels are ready to operate with use of external switch unit as well as radio remote control (supplied optional). Flexible hoses of various diameters from 100mm to 150mm and lengths up to 10m simplify the servicing of vehicles and help to provide a safer workplace. The reel also includes a hose guide and mounting brackets as well as 2 side sheaves. Each spring driven reel is fully adjustable in tension to give the retraction an release strength. All motor driven hose reels are equipped with safety limit switches which limit hose winding process. Remote controlled operated hose reels feature additional intermediate position which can be programmed with use of the remote control unit. Flexible hoses may be provided with a variety of inlet nozzles depending on the vehicle being serviced. The inlet nozzle is then connected to the vehicle exhaust pipe. The outlet of the reel is designed to connect flexible hose or ducting with an outside diameter of 160mm.



Hose Reels

Dimensions

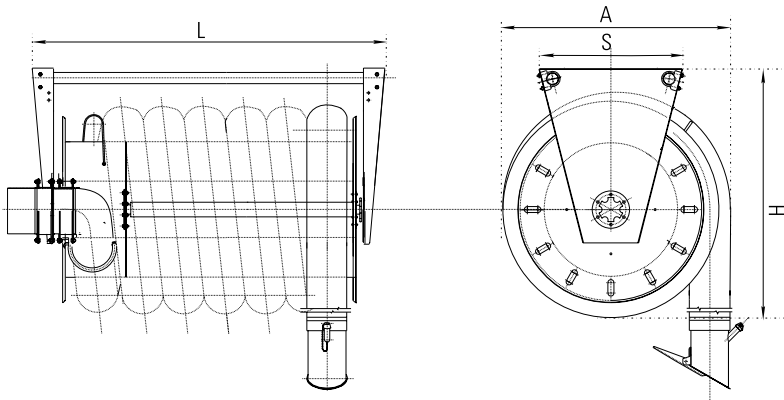

Performance Features

- Nozzle options:
Stainless steel
Rubber nozzle
- Hose reels types:
Spring Driven
Motorised (manual control)
Motorised (remote controlled)
- Hose lengths up to 10m
- 160mm outlet
- Possibility to connect hose reel to:
Fan
Flexible hose
Duct

| Type | Diameter (mm) | Length of flexible hose (m) | Max. length of flexible hose (m) | Weight without/with hose (kg) | Dimensions | | | |
|--|---------------|-----------------------------|----------------------------------|-------------------------------|------------|------|-----|-----|
| | | | | | S | L | H | A |
| W04-SP-10010 W04-NP-10010 W04-NR-10010 | 100 | 10 | 14 | 56/67 | 480 | 1045 | 780 | 810 |
| W04-SP-12510 W04-NP-12510 W04-NR-12510 | 125 | | 12 | 56/70 | | | | |
| W04-SP-15010 W04-NP-15010 W04-NR-15010 | 150 | | 10 | 56/73 | | | | |

Mounting Options

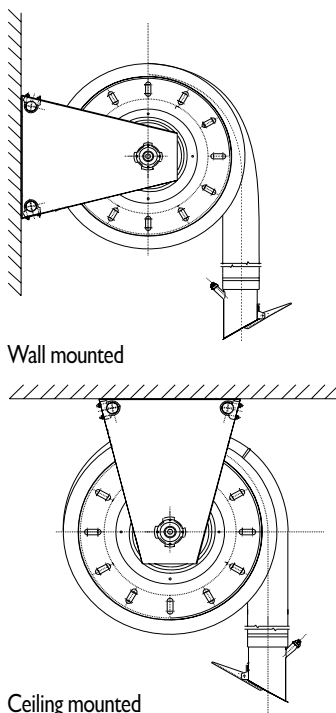

Technical Data

