



101237

Rollout PCD

Mobile single-user filter unit for the filtration of dry dust.

Construction:

- radial fan 1,1 kW
- full mobility thanks to two swivel wheels
- three stages of filtration - metal prefilter, cartridge filter, outlet filter with activated carbon coated fabric
- main filter regeneration system with manual control - requires connection to a compressed air system (5 - 5,5 bar)
- main filter clamping mechanism
- heavy duty welded and powder coated construction
- two dust drawers
- transport handles

Parameters:

- maximum air flow: 1200 m³/h
- noise level dB(A)*: 72 dB(A)
- motor power: 1,1 kW
- max operating temp.: 45 °C
- weight: 125 kg

Filter cartridges:

1. 240007 metal mesh filter Coarse 30% (G2)
2. 242080 main filter cartridge (99% efficiency for particles $\geq 0.5 \mu\text{m}$)
3. 240672 outlet filter Coarse 70% (G4)

* At 1 meter distance with extraction arm mounted and maximal airflow

Notes:

Recommended fume arms:

- 101506 Oskar 1620P fume arm, reach 2m
- 101508 Oskar 1630P fume arm, reach 3m

Available accessories and options

- possibility to add a HEPA filter module
- main filter regeneration system with time control

The method of packing and carton sizes:

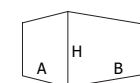

A = 760
B = 900
H = 1600
Weight = 140 kg

All dimensions are in mm

Menegon Sp. z o.o.
Mokry Dwór 6C, 83-021 Mokry Dwór, PL
tel: +48 58 301 28 38 info@menegon.com.pl
www.menegon.com.pl

All rights reserved. This document including constructional and technical information as well as trademarks and brand names are law protected and are property of Menegon Sp. z o.o. The producer reserves the right to introduce changes in construction without prior notification.

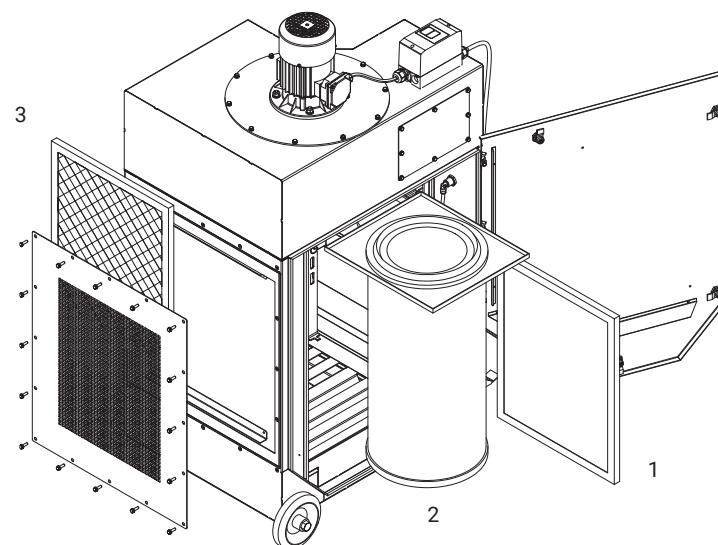
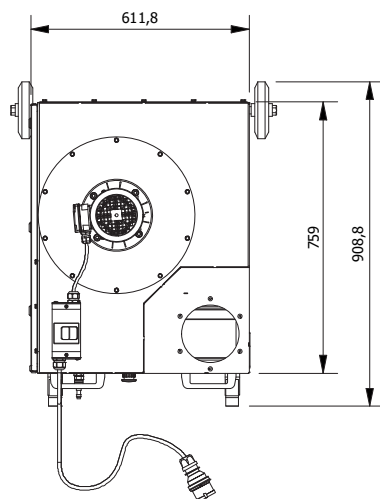
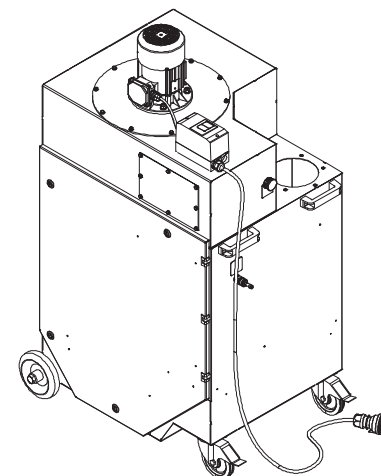
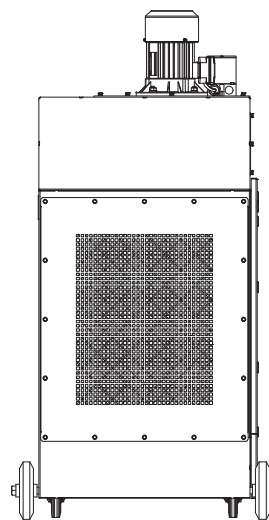
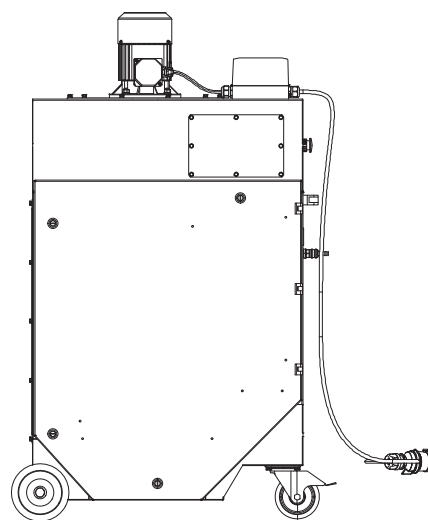
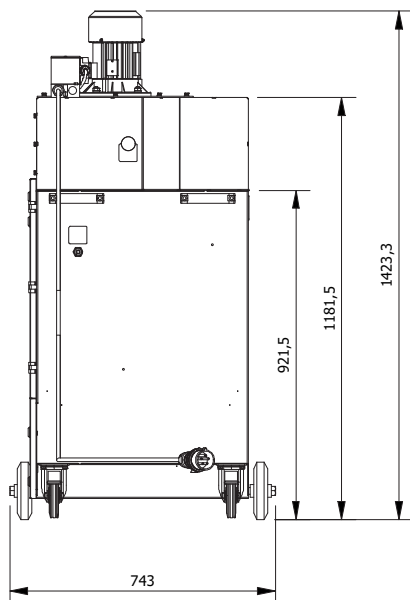

AVAILABLE CONFIGURATIONS OPTIONS

IDENTIFIER	ARM	ARM REACH	POWER SUPPLY*
SRZ3-PCD-NOA	-	-	3~ 400V 50Hz 1~ 230V 50Hz
SRZ3-PCD-OC1620P	1 x Oskar 1620P	2	
SRZ3-PCD-OC1630P	1 x Oskar 1630P	3	

*Depending on the ordered device version